

ENVIRO-SEPTIC LINE ELEVATION TABLE

SECTION	1	2	3	4	5	6	7	8	9	10	11	12	13	14	15	16	17	18	19
LINE NUMBER	1	2	3	4	5	6	7	8	9	10	11	12	13	14	15	16	17	18	19
TOP OF LINE	11.7																		
BOTTOM OF LINE	10.7																		

- NOTES:
 1. BOUNDARY SUPPLIED BY LAFAYETTE SURVEY, HAMPSHIRE, IRL.
 2. SLOPE TO BE USED THROUGHOUT THE PROJECT IS 1/8" PER FT. UNLESS OTHERWISE NOTED.
 3. SLOPE SHALL BE 40% MINIMUM TO BE USED ANYWHERE THE COMPONENT IS INSTALLED.
 4. ALL CONCRETE SHALL BE 3000 PSI MINIMUM STRENGTH.
 5. CONCRETE BARS SHALL BE #4 REBAR WITH 18" ON CENTER.

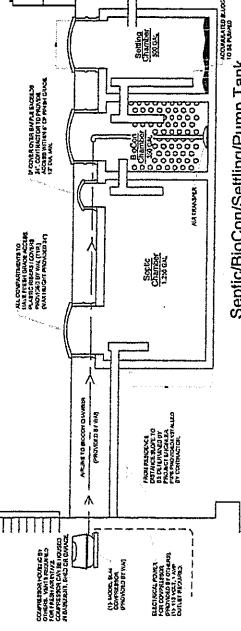

SECTIONAL ELEVATION [A] - [A]

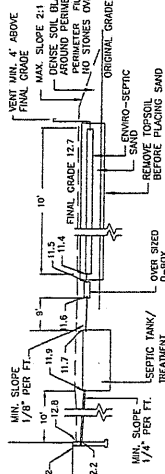

** ALL FILL AND SAND TO BE FREE OF DEBRIS **
NOT TO SCALE

SECTIONAL ELEVATION [B] - [B]

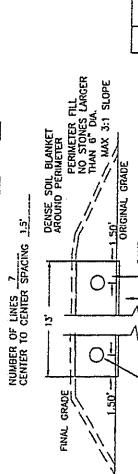

** ALL FILL AND SAND TO BE FREE OF DEBRIS **
NOT TO SCALE

DESIGN INTENT
 BOTTOM OF ENVIRO-SEPTIC PIPE TO BE NO LOWER THAN ORIGINAL GRADE
 RAISED STRAIGHT CONNECTION SYSTEM
 22/45° CONNECTION SYSTEM

SPOT ELEVATIONS
 (A) (B) (C) (D) (E) (F) (G) (H) (I) (J) (K) (L) (M) (N) (O) (P) (Q) (R) (S) (T) (U) (V) (W) (X) (Y) (Z)

PIPE SPACING
 SPACING BETWEEN LINES OF CENTER TO CENTER
 1.5' 2.0' 2.5' 3.0' 3.5'

SOIL DATA
 447 PROCEDURE FOR SCS MAP
SAND TYPE
 SLOPE DESIGN < 15%; TYPE 'A' SAND
 SLOPE DESIGN > 15%; TYPE 'B' SAND

MAINTENANCE
 PROPER MAINTENANCE AND CARE ARE REQUIRED FOR SEPTIC SYSTEM TO FUNCTION PROPERLY. THE FOLLOWING ARE SOME ITEMS THAT MAY SHORTEN SYSTEM LIFE:
 * GARAGE DISPOSAL UNITS
 * TOXIC CHEMICALS
 * EXCESSIVE USE OF WATER
 * IMPROPERLY INSTALLED OR MAINTAINED PUMP
 * TANK SHOULD BE INSPECTED AT LEAST ONCE A YEAR AND CLEANED WHEN NECESSARY

ENVIRO-SEPTIC[®] CONCRETE PIPES
 PAIR END JOINING
 TYPICAL JOINT
 OTHER JOINTS
 OTHER JOINTS

PIPE INDEX
 (A) 4" PVC SCH. 40 PLASTIC PIPE THROUGH TANK VOLUME PROVIDED
 (B) 4" PVC SCH. 40 PLASTIC PIPE W/ GLUE JOINTS STIC PIPE
 (C) 4" S40 SOLID STIC PIPE
 (D) 4" S40 PERFORATED PLASTIC PIPE

SYSTEM REQUIREMENTS
 MIN. RATE REQUIRED: 17 GPM
 DAILY FLOW VOLUME: 300 GPD
 TANK VOLUME PROVIDED: 2220 GAL.
 TANK VOLUME REQUIRED: 2220 GAL.

PERCOLATION TEST DATA
 DATE: 5-17-20
 WATER: 37"
 HIGH WATER TABLE: 37"

TEST PIT DATA
 DATE: 5-17-20
 WATER: 37"
 HIGH WATER TABLE: 37"

PROPOSED SEPTIC DISPOSAL FACILITIES
 FOR
 MICHAEL BROWN
 IN
 HAMPTON, NH
 51 LAFAYETTE ROAD

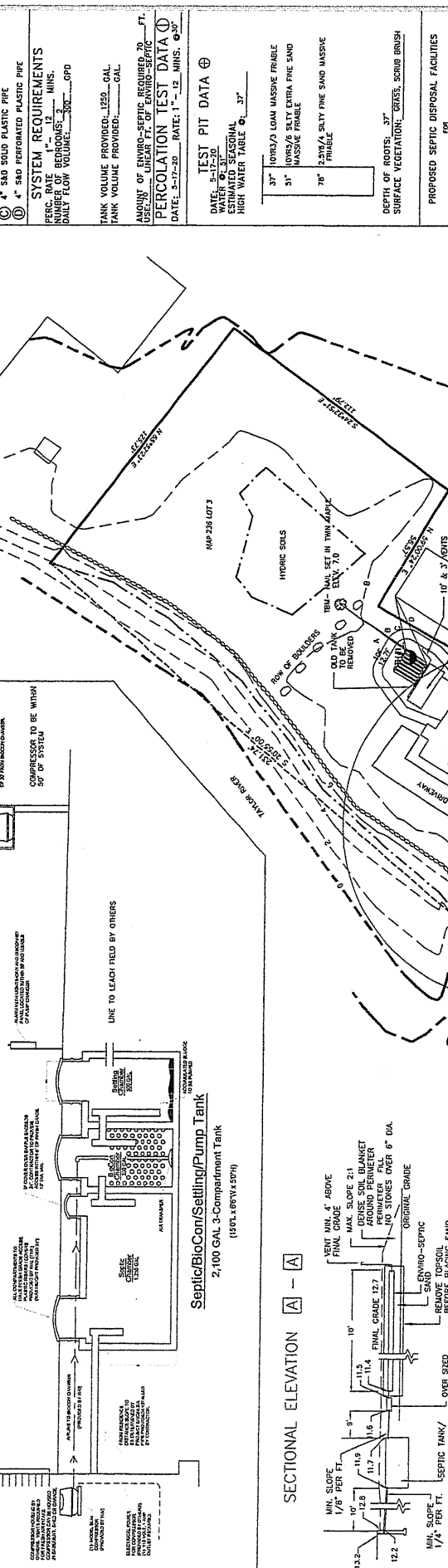

LOCATION MAP (NOT TO SCALE)
 NOTE: BEFORE INSTALLATION, INSTALLER SHOULD VERIFY LOCATION, ELEVATION AND DISTANCES OF ALL EXISTING UTILITIES AND PLUMBING. ELEVATIONS MUST BE CHECKED AGAINST DESIGNER'S RECORD DRAWINGS IF ANY DISCREPANCIES ARE FOUND.

RAISED STRAIGHT CONNECTION SYSTEM
 TO BE INSTALLED
 10' x 12" CONCRETE TO BE INSTALLED
 PROPOSED TREATMENT TANK
 THE DISTANCES:
 A - 10'
 B - 4'
 C - 20'
 D - 10'
 E - 10'

RAISED STRAIGHT CONNECTION SYSTEM
 TO BE INSTALLED
 10' x 12" CONCRETE TO BE INSTALLED
 PROPOSED TREATMENT TANK
 THE DISTANCES:
 A - 10'
 B - 4'
 C - 20'
 D - 10'
 E - 10'

REVIEWED AND APPROVED
 V. W. DINGMAN CONSULTING ENGINEERS
 14 LUDGELD ROAD
 PELHAM, NH 03076
 (603) 881-1373
 vdingman@dingman.com

OWNER: MICHAEL BROWN
 51 LAFAYETTE ROAD
 PELHAM, NH 03076

DATE: 05/26/2020
CHECKED BY: VMD
SCALE: 1" = 20'
DRAWING #:

NO.	DATE	REVISIONS	BY
1	7-18-20	REVIS PER INCHES & AIDS	VMD

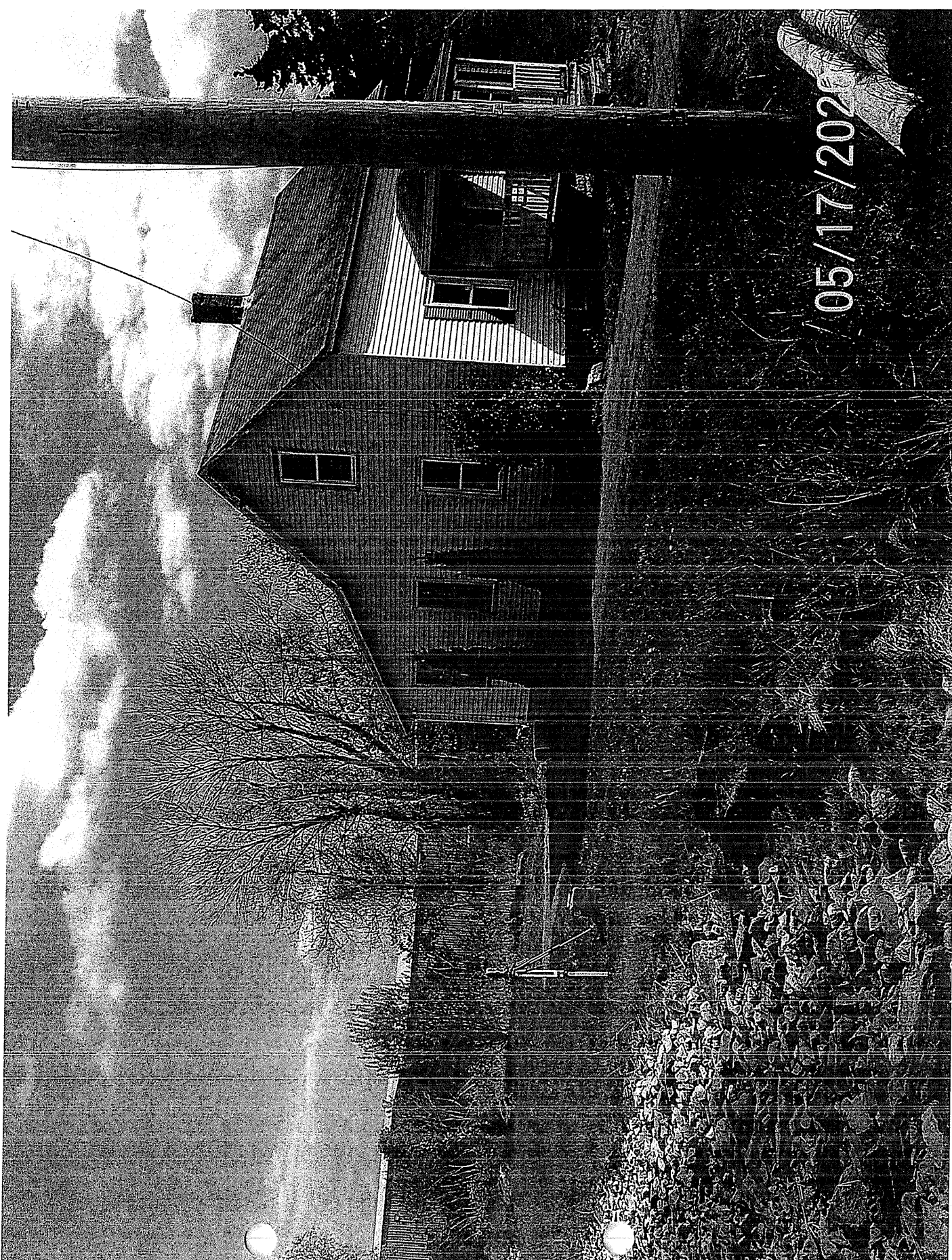

05/17/2020